

ASSEMBLING INSTRUCTION

LEGEND

NUMBER PLATE HONDA CB 1000R (21-23)

HN1400-22

WWW.BARRACUDAMOTO.COM

- | | | |
|--|---|--|
| 1. BRACKET
STAFFA
SOPORTE
HALTERUNG
SUPPORT | 2. NUMBER PLATE
TABELLA PORTANUMERO
SOPORTE PORTANUMERO
NUMMERNTAFEL
SUPPORT NUMERO | 3. COUNTERSUNK ALLEN M6X16
VITE A TESTA SVASATA M6X16
TORNILLO AVELLANADO M6X16
COUNTERSUNK-SCHRAUBE M6X16
VIS FRAISEE M6X16 |
| 4. NUT Ø8
DADO Ø8
TUERCA Ø8
MUTTER Ø8
ÉCROU Ø8 | 5. NEOPRENE 20X20 mm
NEOPRENE 20X20 mm
NEOPRENO 20X20 mm
NEOPREN 20X20 mm
NÉOPRÈNE 20X20 mm | |

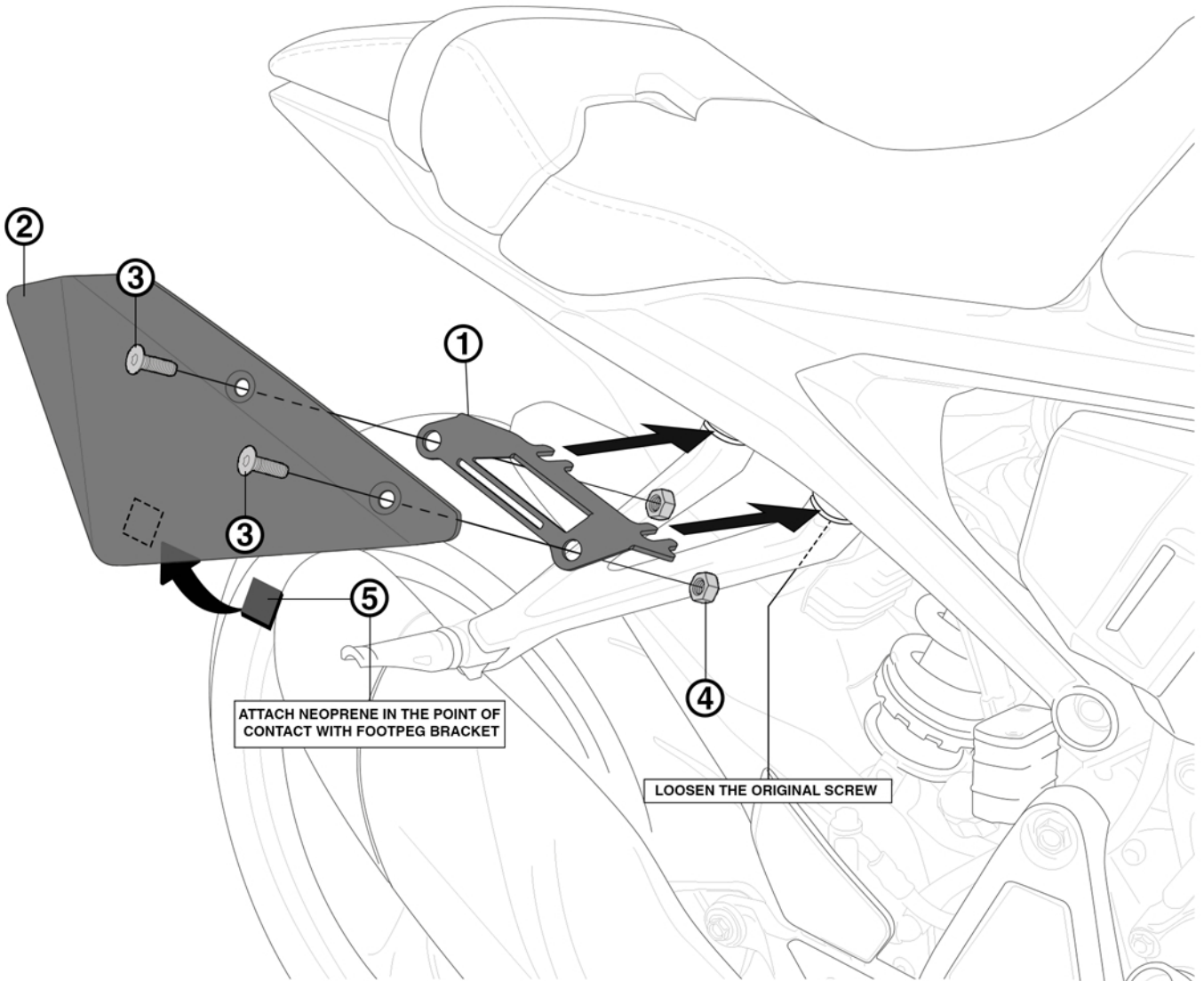

ATTACH NEOPRENE IN THE POINT OF CONTACT WITH FOOTPEG BRACKET

LOOSEN THE ORIGINAL SCREW



- EN:** ATTACH THE STICKER AFTER TIGHTENING THE BRACKET SCREWS
- IT:** ATTACCARE L'ADESIVO DOPO AVER STRETTO LE BRUGOLE DELLA STAFFA
- ES:** APLICAR EL ADHESIVO DESPUÉS DE APRETAR LOS TORNILLOS DEL SOPORTE
- DE:** TRAGEN SIE DEN KLEBER NACH DEM ANZIEHEN DER BEFESTIGUNGSSCHRAUBEN AUF
- FR:** APPLIQUER L'ADHÉSIF APRÈS AVOIR SERRÉ LES VIS DU SUPPORT

BARRACUDA

Cod.: HX7400-21
Descr.: SIDE STICKER

APPLYING YOUR DECAL

<p>1. Clean</p> <p>Clean the area with rubbing alcohol and let it dry.</p>	<p>2. Align</p> <p>Align the decal with the surface.</p>	<p>3. Apply</p> <p>Apply your decal slowly and smoothly. Use a soft cloth to remove any air bubbles.</p>	<p>4. Heat</p> <p>Warm the decal with a heat gun or hair dryer to ensure it adheres properly.</p>
--	--	--	---